



▲ AERIAL WEST



▼ ROOF PLAYGROUND



▲ MASTERPLAN

DESIGN PROCESS

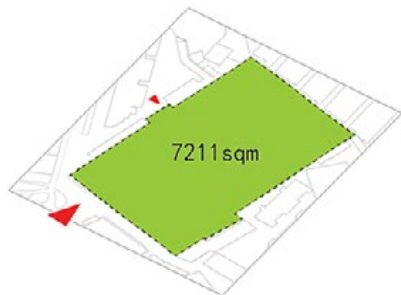

01 SITE AREA AND BOUNDARY

The site footprint is a total of 7,211 square meters, with a main entry from the northwest corner and a possible side entry from the north.

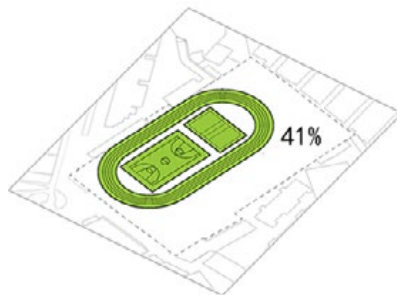

02 AREAS OF SPORTS FACILITIES

Placing a required 200 square meter running track onto the site takes up 41% of the total site footprint, leaving little space left for any school building.

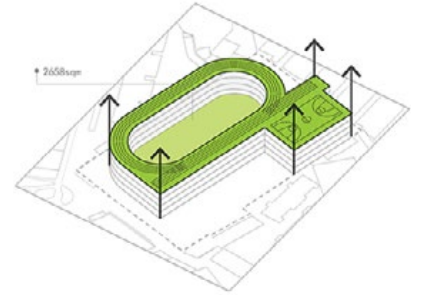

03 EXTRUSION OF MASSING

By lofting the 200m running track, 100m sprinting track and basketball court 4 stories up, a 2,858 square meter courtyard is created by the resulting building volume.

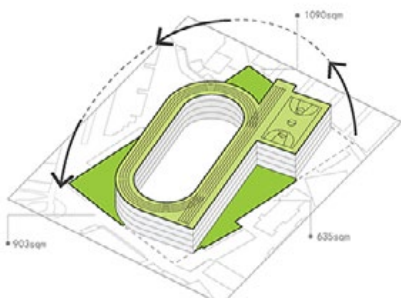

04 ROTATION OF MASSING

By rotating the massing, a series of courtyard spaces are shaped between the site boundary and the building in all directions of the volume.

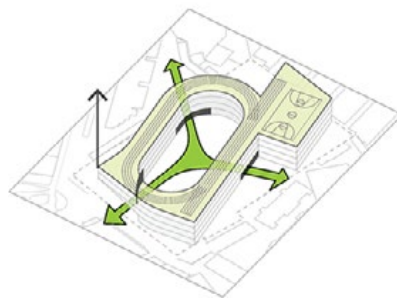

05 GROUND SPACE CONTINUITY

3 parts of the ground floor are removed to allow for continuity of pedestrian circulation on the ground, connecting to the main entry, side entry, and south-facing garden.

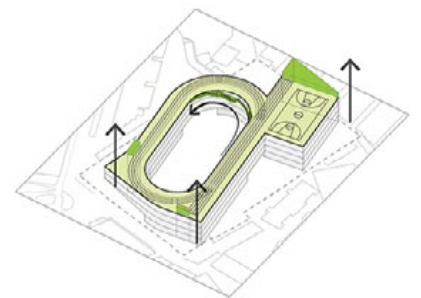

06 VERTICAL CIRCULATIONS

4 stairwells, 1 elevator, and 1 open-air stair connects all levels of the building vertically.



▲ AERIAL EAST



▼ ORIGINAL SITE



▲ WEST MAIN ENTRANCE



▼ MAIN COURTYARD ENTRANCE



▲ MAIN COURTYARD

▼ PHYSICAL MODEL

